

# ORYX

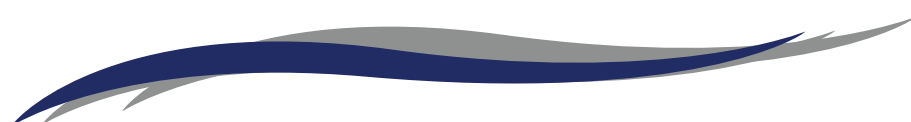

**BEST YACHTS**  
MALDIVES



# ORYX 40



**BEST YACHTS**  
MALDIVES



[info@bestyachtsmaldives.com](mailto:info@bestyachtsmaldives.com)

# ORYX 40

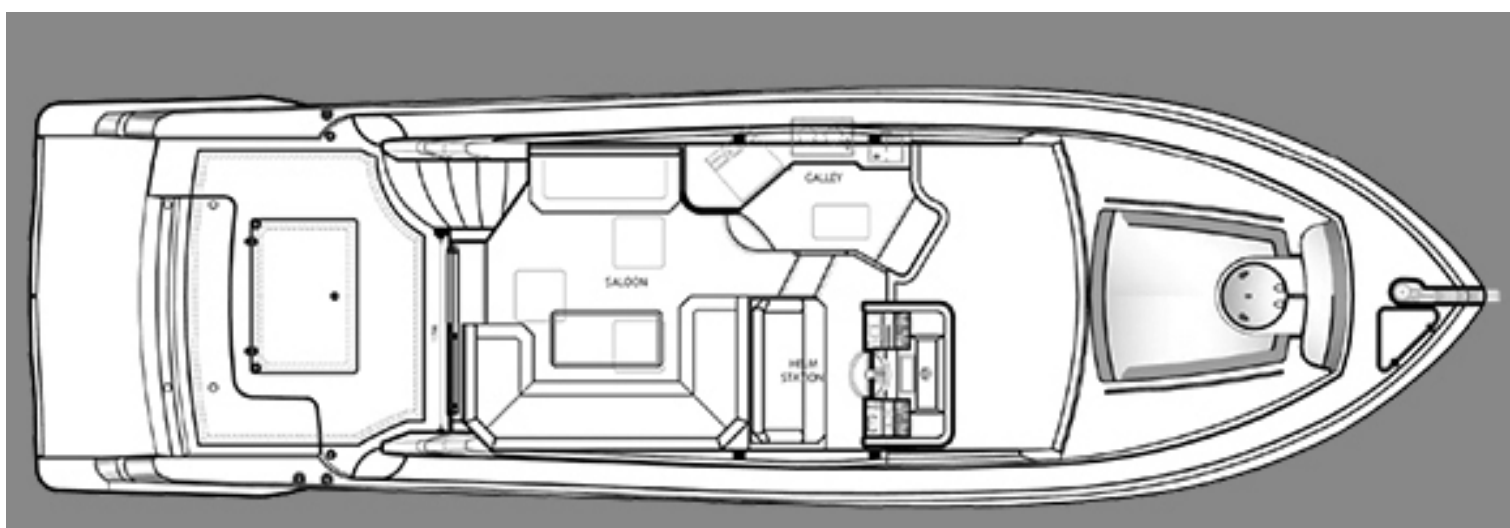
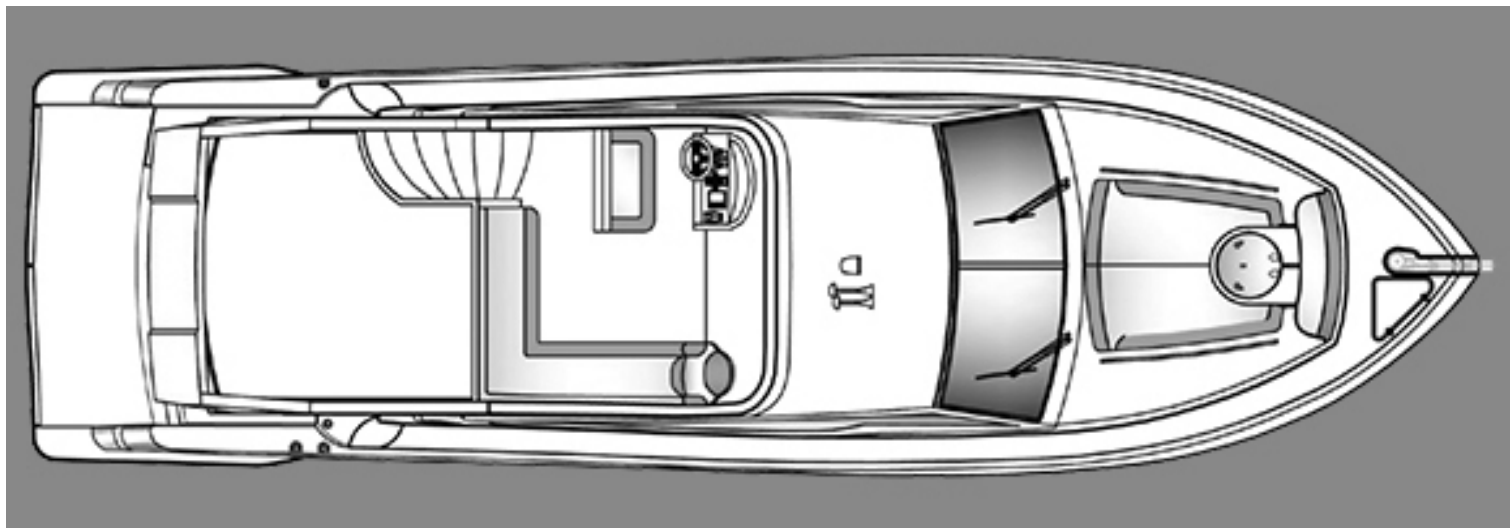
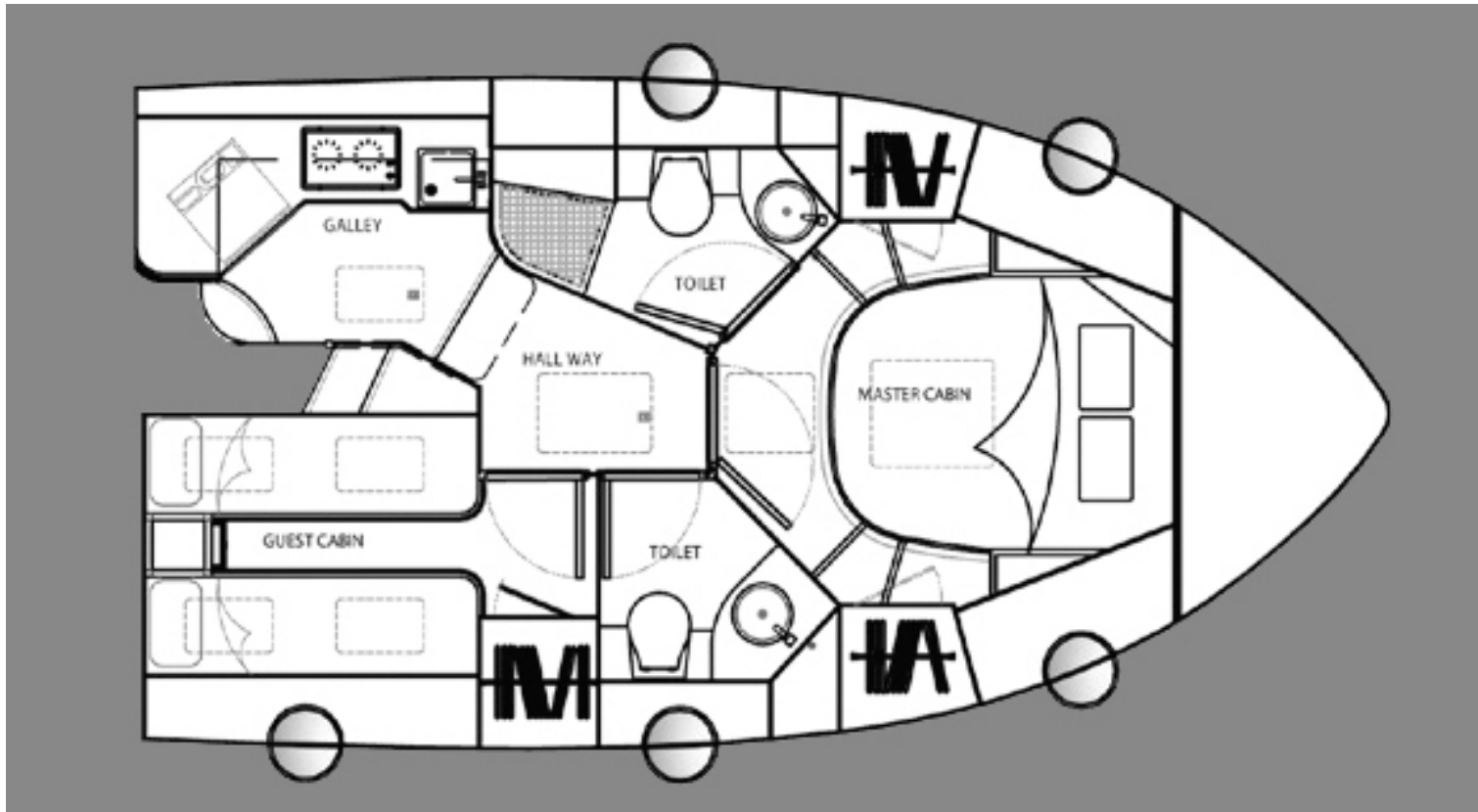

**BEST YACHTS**  
MALDIVES



[info@bestyachtsmaldives.com](mailto:info@bestyachtsmaldives.com)

# ORYX 40

## SPECIFICATIONS

Type	Oryx 40
Built	2008
Length	12.9 M (40 FT)
Beam	3.73 M (12 FT)
Draft	0.68 M (2 FT)
GT	450
Hull	Fiber
Engines	Volvo Penta D6 x2
Generators	Onan x 1
Speeds	20 Knots (cruising)
Fuel capacity	800 Ltr
Cabins	1 Double
Guests by day trip	10
Guests by overnight	2
Crew	3
Flag	Maldivian

**BEST YACHTS**  
MALDIVES



[info@bestyachtsmaldives.com](mailto:info@bestyachtsmaldives.com)